

NanoAccess®

NA4DM 4 Door Controller - basic power

NA4DMPL 4 Door Controller - power package (incl. 12 and 24 volt outputs for locks)

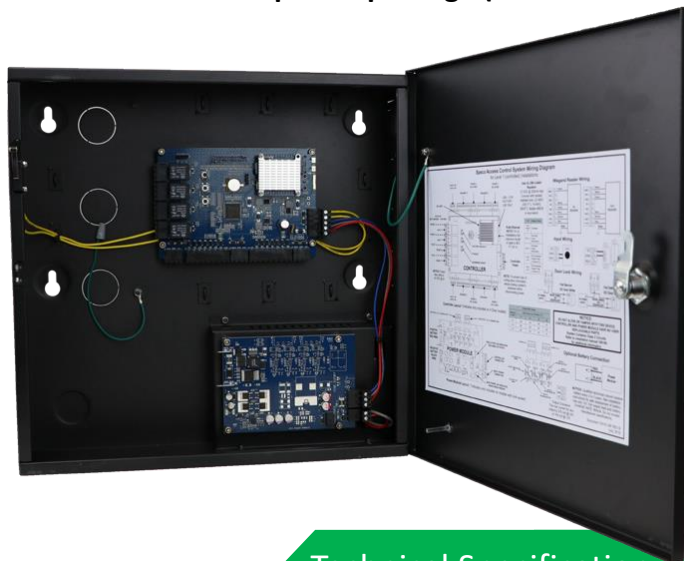

Features

- Each module functions as a Server or Expansion panel
- Each module functions as an Elevator panel
- Browser managed right out of the box
- Embedded Linux operating system
- 8 Readers (4 In/4 Out)
- 8 Relays (Lock/Aux)
- 12 Inputs (REX, DPS, Aux) Global
- UL Listed - 294 Series 7
- 1 year warranty
- Part Numbers: NA4DM and NA4DMPL
- Note: This document is subject to change without notice

Technical Specification

| Model | 2DM | 2DMPL |
|--|--|---|
| Processor | Quad Core Cortex, 1.5 GHz | |
| Memory | 1GB DDR3 & 8GB eMMC | |
| Operating System | Embedded Linux | |
| Transactions | > 60 per second | |
| System Power Requirements | 115VAC @ 1.5A | |
| Operating Temperature | 50°F to 95°F (10°C to 35°C) | |
| Enclosure Size (W x H x D) | 14.25 x 14.25 x 3.75in (362 x 362 x 95mm) | |
| Internal Power Supply | Controller & Readers Only | Controller, Readers & 12V and 24V DC for Door Locks |
| List Lock out put power | NA | 12 VDC 700MLS, 24 VDC 350MLS |
| Battery Backup | Controllers & Readers Only | Controllers, Readers, & Door Locks |
| Recommended Battery Type (battery is not included) | 12V, 7AH, Sealed Lead Acid with 0.187 inch terminals | |
| Standby Power Requirement | 400mA @ 12V | 450mA @ 12V |
| Readers (Wiegand) | 8 Total, One In & One Out Reader for Each Door | |
| Reader Power | 300mA @ 12V Max per Reader 1000mA @ 12V Max per System | |
| Request to Exit (REX) Inputs | 4 Total, One for Each Door | |
| Door Position (status) Inputs | 4 Total, One for Each Door | |
| Auxiliary Input | 4 Total, General Purpose | |
| Tamper Digital Input | Yes, | |
| Power Fault Digital Input | Yes, | |
| Door Lock Outputs | 4 Form C Relay, 24V @ 2.0A | |
| Auxiliary Outputs | 4 Form C Relay, 24V @ 2.0A | |