

NanoAccess®

NA2DM 2 Door Controller - expandable up to 4 doors, basic power

NA2DMPL 2 Door Controller - expandable up to 4 doors, power package

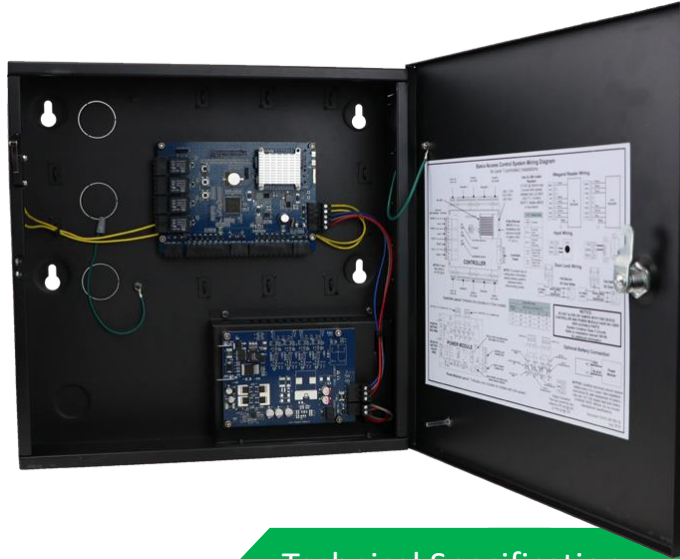

Features

- Each module functions as a Server or Expansion panel
- Each module functions as a Elevator panel
- Browser managed right out of the box
- Embedded Linux operating system
- 4 Readers (In/Out)
- 4 Relays (Lock/Aux)
- 6 Inputs (REX, DPS, Aux) Global
- UL Listed - 294 Series 7
- 1 year warranty
- Part Numbers: NA2DM and NA2DMPL
- Note: This document is subject to change without notice

Optional Accessory

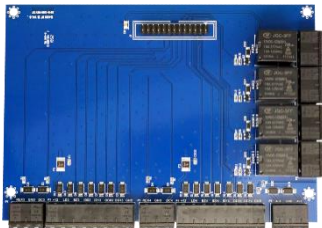

2 Door Expansion Module

Part Number: NAACM2D

Technical Specification

Model	NA2DM	NA2DMPL
Processor	Quad Core Cortex, 1.5 GHz	
Memory	1GB DDR3 & 8GB eMMC	
Operating System	Embedded Linux	
Transactions	> 60 per second	
System Power Requirements	115VAC @ 1.5A	
Operating Temperature	50°F to 95°F (10°C to 35°C)	
Enclosure Size (W x H x D)	14.25 x 14.25 x 3.75in (362 x 362 x 95mm)	
Internal Power Supply	Controller & Readers Only	Controller, Readers & 12V and 24V DC for Door Locks
List Lock out put power	NA	12 VDC 700 MLS, 24VDC 350 MLS
Battery Backup	Controllers & Readers Only	Controllers, Readers, & Door Lock
Recommended Battery Type (battery is not included)	Powersonic PS-1270-FI or Similar 12V, 7AH, Sealed Lead Acid with 0.187 inch terminals	
Standby Power Requirement	400mA @ 12V	450mA @ 12V
Readers (Wiegand)	4 Total, One In & One Out Reader for Each Door	
Reader Power	300mA @ 12V Max per Reader 1000mA @ 12V Max per System	
Request to Exit (REX) Inputs	2 Total, One for Each Door	
Door Position (status) Inputs	2 Total, One for Each Door	
Auxiliary Input	2 Total, General Purpose	
Tamper Digital Input	Yes	
Power Fault Digital Input	Yes	
Door Lock Outputs	2 Form C Relay, 24V @ 2.0A	
Auxiliary Outputs	2 Form C Relay, 24V @ 2.0A	